

# Sunkist

## Pro Series Citrus Juicer Information

Suggested List

Effective: November 1, 2017

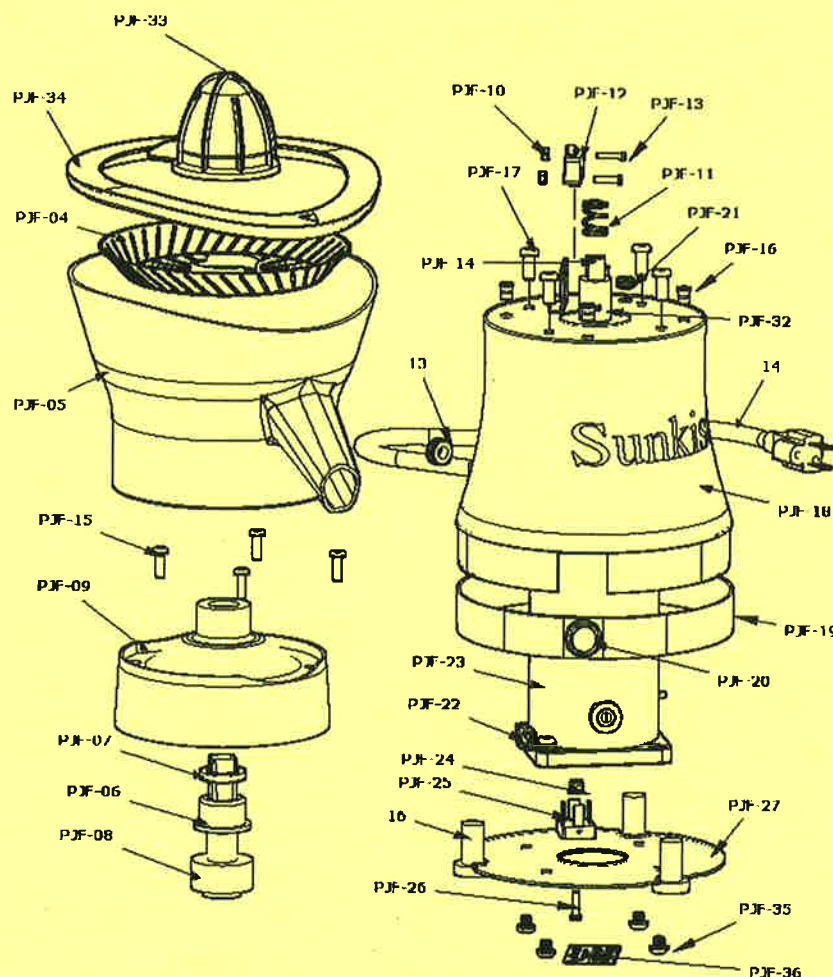

### Specifications

- Chrome plated steel housing. Corrosion proof plastic dome, spout & bowl support
- Listed by.....UL, CUL, CE, CCC, EPH
- Shipping weight.....13 lbs.
- Net weight.....11½ lbs.
- Overall dimensions.....11¼" tall, 7½" diameter
- Carton size.....9½" W x 9¼" L x 13" H
- Motor.....Hi-Torque 18.9 in-lbs., 900 RPM

All prices quoted are FOB Rancho Cucamonga, CA and are subject to change without notice. These prices are also listed in AutoQuotes. The amount of any present or future tax shall be paid by the purchaser. There is **no** minimum order fee for orders we drop ship to your customer, or for orders being sent to service centers for equipment waiting to be repaired. A service charge of \$10.00 will be added to all orders less than \$50.00 that are shipped to your Location or one of your warehouses. CONTACT: Sunkist Foodservice Equipment Customer Service: 800.383.7141. FAX orders to 909.822.2125. **Products must not be returned without a return authorization #.**

**[www.sunkistequipment.com](http://www.sunkistequipment.com)**



## Pro Series Citrus Juicer Information

*Suggested List      Effective: November 1, 2017*

### Complete Juicer Units

<u>Model #</u>	<u>Type</u>	<u>Units per Carton</u>	<u>Weight per Carton</u>	<u>Cost</u>
PJF-A1	AC 115/60	1	13 lbs.	\$299
PJF-B1	AC 230/50	1	13 lbs.	\$299
PJF-B2	AC 230/60	1	13 lbs.	\$299
PJF-A1OR <sup>1</sup>	AC 115/60	1	13 lbs.	\$299
PJF-B1OR <sup>1</sup>	AC 230/50	1	13 lbs.	\$299
PJF-B2OR <sup>1</sup>	AC 230/60	1	13 lbs.	\$299

### Individual Parts - Optional

<u>Part #</u>	<u>Description</u>	<u>Cost</u>
PJF-04	Strainer	\$ 50.00
PJF-05/PJF-05OR <sup>1</sup>	ABS Dome/Spout Assembly	\$ 34.00
PJF-06	Bearing-Delrin	\$ 19.00
PJF-07	Rotary Seal	\$ 18.00
PJF-08	Stainless Steel Female Coupling	\$ 57.00
PJF-09/PJF-09OR <sup>1</sup>	ABS Dome Covering	\$ 26.00
PJF-10	4-40 Nylock Nut	\$ 1.50
PJF-11	Spring	\$ 6.00
PJF-12	Micro Switch	\$ 12.00
13	Electrical Cord Bushing	\$ 7.00
PJF-13	4-40 x .625 Button Head Screw	\$ 1.50
14	Electrical Cord	\$ 25.00
PJF-14	Stainless Steel Male Coupling	\$ 33.80
PJF-15	10-32 x .625 Button Head Screw	\$ 1.50
16	Rubber Feet (3)	\$ 9.00
PJF-16	10-32 Rivet Nut	\$ 3.00
PJF-17	¼-20 x .625 Button Head Screw	\$ 1.50
PJF-18	Chrome Motor Housing	\$100.00
PJF-19/PJF-19OR <sup>1</sup>	ABS Trim Ring	\$ 12.00
PJF-20	On/Off Switch	\$ 10.00
PJF-21	Upper Grommet	\$ 2.00
PJF-22	Wire Clip	\$ 2.00
PJF-23A	Motor, 115/60	\$200.00
PJF-23B	Motor, 230/50	\$200.00
PJF-23C	Motor, 230/60	\$200.00
PJF-24	6-32 Nylock Nut	\$ 1.50
PJF-25	Power Rectifier	\$ 22.00
PJF-26	6-32 x .625 Button Head Screw	\$ 1.50
PJF-27	Base Plate	\$ 36.00
PJF-32	Roll Pin 1/8"	\$ 2.00
PJF-33	Extracting Bulb	\$ 26.00
PJF-34/PJF-34OR <sup>1</sup>	Flexible Trim Ring	\$ 10.00
PJF-35	¼-20 x ¼ Screw	\$ 2.00

<sup>1</sup>OR = Orange